



SATURATION SYSTEM 03

GENERAL INFO

Type

Mobile Sat/TUP System
configured by DCN in 2017,
200MSW rated

Manufactured by

DCN Diving

Year of build

2009

Max. Sat Divers

8

Class

Lloyds Certified

Total Bell Volume

4.9 m³

Bell Type

Single Bell

Evacuation

Hyperbaric Rescue Craft 15 man

Configuration

1x Twin lock living chamber

1x Single lock HRC including LARS

1x 3-man bell

1x bell-LARS Double Ram A-Frame

1x Dive & Sat Control 20ft Container

2x Equipment Support Container



GENERAL

Operating Depth

Currently certified for 200msm
Split level possibility

Launch Direction

Moonpool or side launched

TUP Diving

Alternatively the system can be used for TUP
Diving

Hyperbaric Rescue Chamber

Self-contained Tilted Launch System including
life support package

Sea-fastening

Dedicated grillage included

Fire frightening

External / internal deluge / firefighting systems

Planned Maintenance

DiveCert / IMCA D018

Dimensions / Requirements

Electrical Requirements

440 -460V / 60Hz / 630Amp + redundant supply

Dimensions

See the sketches included on the next page

Offshore Lifting

Setup in compliance with offshore rules

Weights

65T LARS + main chamber + TUP + winch skid +
ramp 14T Bell + standoff + clump 22T Dive
control + machinery container + standoff
frames 11T Reclaim container + standoff frame
12T Hyperbaric rescue chamber 15T Umbilical
winch + umbilical

Launch & Recovery System

Integrated above main chamber and forming
one structural part with base frame / grillage
Hydraulically stabilized cursor system
Remote control / dedicate control forward of
winch skid
Main Winch, Norson self-reeving including
redundant HP
Clump Weight Winch, Comex hydraulic powered
Wire counters for main-wire and clump wire
Emergency recovery via integral air winch
Power sheave for umbilical handling

Closed Dive Bell

Volume of 4.9m³
Side trunk docking with TUP system
50 meter excursion and 55m standby umbilical
Reclaim diver helmets for working divers
72h life support including emergency onboard
gas supplies, onboard oxygen make up system,
onboard carbon dioxide scrubbers and bell
heater
Internal / external CCTV, lightening and 2way
voice comms

TUP Chamber

Integrated into LARS Frame
Side docking diving bell
Vertical chamber allows divers to undress easily
Shower, washing, toilet facility and sanitary system
600mm equipment lock
Third 600mm trunk available for additional chamber
CCTV, lightening and 2way voice comms.
Sound powered phone

Main Chamber

2.2 meter diameter
4man accommodation
CCTV monitoring
Medical/Food lock
Built in breathing system (BIBS)
CCTV, lightening and 2way voice comms.
Sound powered phone

SAT & Dive Control

3 Man bell control panel
3 Diver surface air / mixed gas dive panel
Split panels for SAT and dive control
Diver gas reclaim control panel
Amron mixed gas communications system
(Unscrambles)
Electrics, analysers, hot water temp monitoring,
carbon dioxide and oxygen analysis of divers gases
Clear comm systems (deck, bridge, rov, etc.)
Digital Edge Inspection / recording system +
additional 16channel black box recording system

Life support Unit (Reclaim Unit)

Electric main distribution system
Dual diver hot water unit (100% redundancy)
Gas reclaim (working depth depending but on
average 80% efficiency)

Life Support Unit (Chiller Unit)

Electric emergency distribution system
Chamber potable water unit (hot/cold)
Environmental control unit (100% redundancy)

Bell Winch / Umbilical

200m Length
Standard Fibron Courtland bell umbilical
The Hydraulic self-reeving umbilical winch
Dedicated HPU

Hyperbaric Rescue Unit

Designed for 15 man capacity
Services as living chamber in proposed configuration
Integrated hospital facilities
72hrs life support (gas + battery power)
BIBS complete with dump, carbon dioxide scrubbers
Dedicated life support package incl. gas quads and
treatment mix

Additional Equipment

Emergency generator
Compressor container with primary and back up air
supplies
HP Gas storage quads / Kelly's
Tooling / Equipment container
Additional living chamber

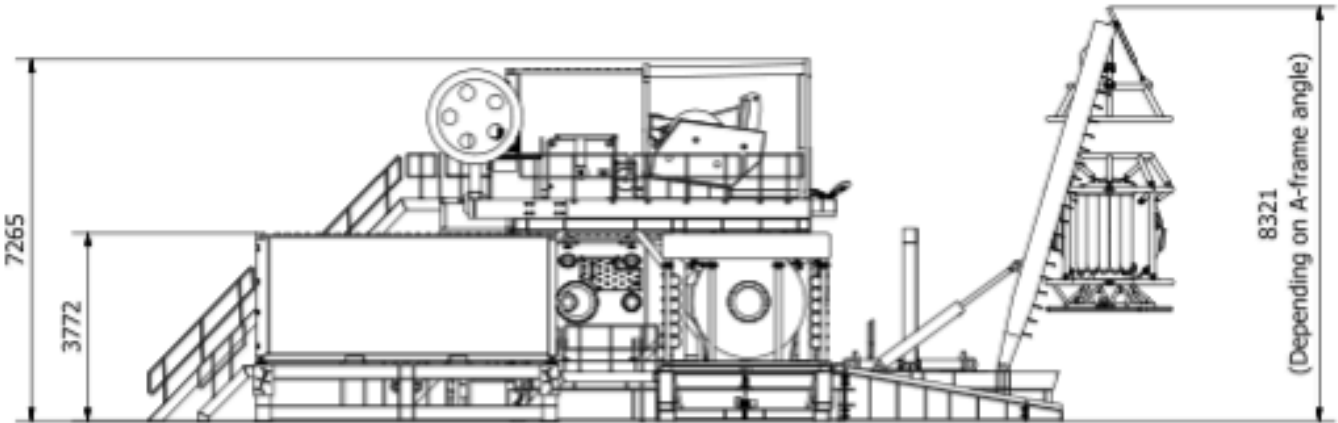

RIGHT VIEW

SCALE: 1 : 100

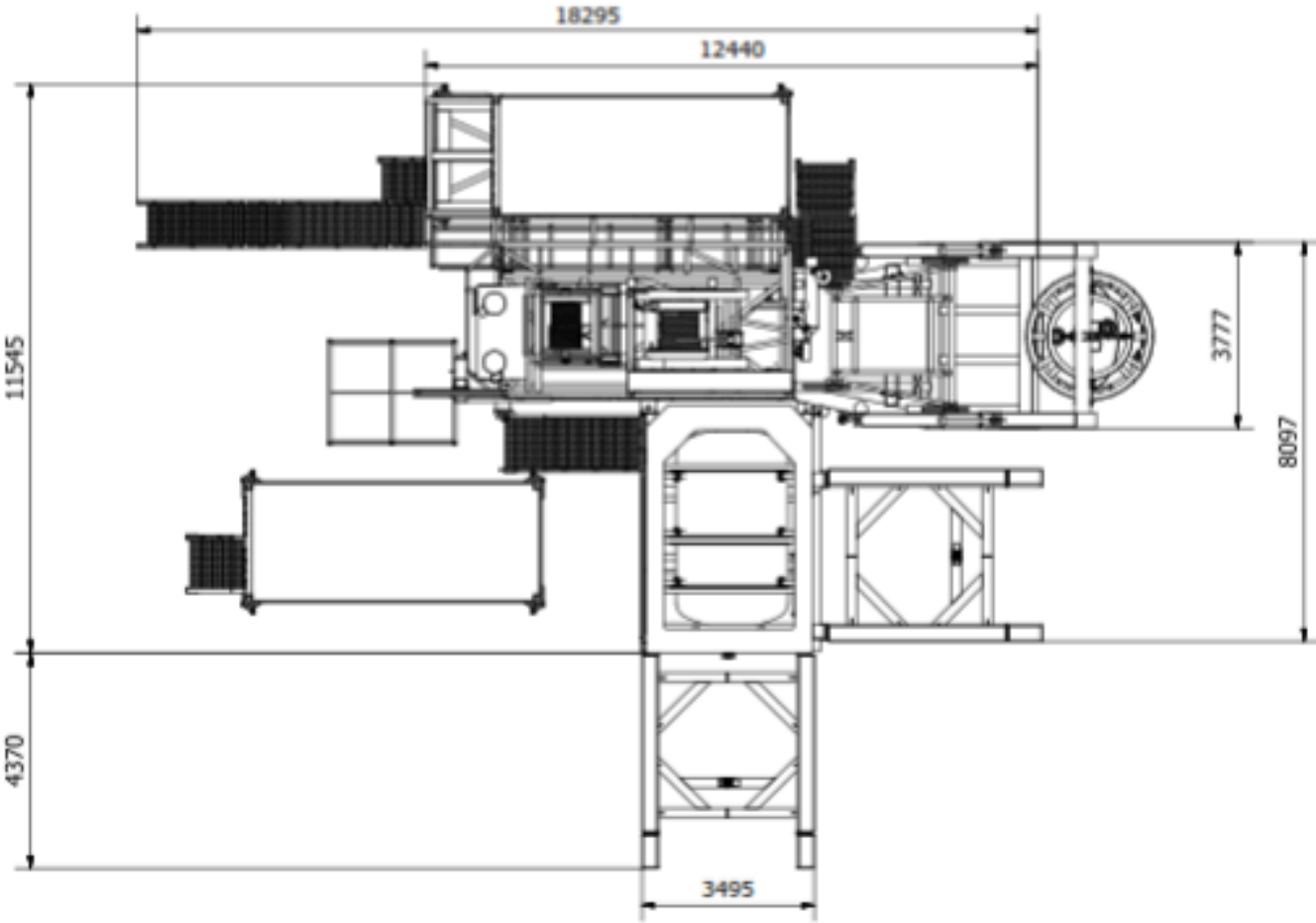

TOP VIEW

SCALE: 1 : 100